

# Technical Data Sheet

## Situclad EWS Fibre-reinforced waterproofing system

### DESCRIPTION:

Situclad EWS is a protective laminate system applied in-situ to provide a smooth, jointless system, which follows the substrate contours, profiles etc. is impact resistant waterproof surface. It forms a continuous membrane which is fully bonded to the substrate.

Based on the proven Aquakem (Aquaguard 101) epoxy waterproofing, Situclad EWS is used as a more comprehensive waterproofing and protection system by forming a laminate membrane, it is more durable than straight applied Aquakem (Aquaguard 101).

Situclad EWS is the recommended system for the waterproofing of interior Concrete / Concrete block walls where an unreinforced coating will crack on mortar joints.

*Situclad EWS is a NO odour system: - Ideal for working in tanks.*

### TYPICAL FEATURES | BENEFITS:

- Compliant with **E3 Internal Moisture**: Internal, Watersplash, section 3.1.1.eg bathroom floor and shower base use.
- Is a solution for **E2/AS1 External Moisture** for waterproofing walls and floors on the internal side
- Compliant with **BRANZ good Trade Practice** guide. Concrete Floors section 8.6.4.
- Based on the proven Aquakem (**Aquaguard 101**) epoxy system.
- Tolerant of application to a slightly damp surface.
- Will bond to **green / fresh** concrete - see cautions below.
- Resistant to peeling and flaking.
- 40 plus years of use in New Zealand.
- Cured Film is non-toxic. – Non-flammable
- Very good abrasion and scuff resistance.
- No odour during application.
- Easily cleaned.
- Excellent adhesion to properly prepared substrates.
- Water-based - No solvents.
- Easily repaired and maintained
- Non-toxic. Non-flammable
- Good impact and abrasion resistance.
- Will not contaminate foodstuffs during application.

### RECOMMENDED USES:

For creating a waterproof finish over Masonry | Concrete | Precast | Plywood | Tilt Slab and Insulated Panel in following:

- Internal wet areas: Bathrooms, kitchens, laundries: on Concrete, plywood, fibre-cement.
- Concrete water tanks – Internal
- Concrete water tanks – External – Must be over-coated to protect from UV – *Refer: Situclad WCS Method Statement for this type of application.*
- Insulated Panel – Internal – Must be over-coated – *Refer: Situclad WCS Method Statement for this type of application.*
- Fibreglass reinforced, exposed floor finishes. Must be over-coated to protect from UV *Refer: Situclad WCS Method Statement for this type of application.* or *Refer: allnex Construction Products for specific advice and finish options.*
- Planters.
- Silos - Internal
- Silos - External – Must be over-coated to protect from UV – *Refer: Situclad WCS Method Statement for this type of application.*

### NOT RECOMMENDED:

- Application below +10°C or when relative humidity is above 85%.
- Application to unsound substrates.
- Application to incorrectly prepared surface.
- Over existing coatings.
- Over untreated steel.
- Application over actively leaking water.
- Not for contact with strong acids, alkalis or aggressive solvent. *Refer: allnex for advice for this type of application.*
- Do not apply to structures with excessive joint movement.
- Not for use on red (clay) bricks, plaster, limed plasters, old paints, old adhesive. *See: surface preparation below.*
- Do not use exposed to exterior UV situations. *Refer: Situclad WCS Method Statement for this type of application.*
- For areas exposed to UV, exterior decks, roofs etc. *Refer: allnex Ultratuff, Terraflex or Situclad WCS system.*
- Floors subjected to heavy traffic without protective glaze coating *Refer: Situclad WCS Method Statement for this type of application.*
- As an exposed wall surface (must be over-coated) *If required as an exposed wall surface Refer: allnex Situclad WCS*

#### Note

allnex generally recommend applying waterproofing to the exterior of a below ground wall.

If it is at all possible to access the below ground exterior wall - use Bituthene 3000 sheet tanking.

Aquakem (Aquaguard 101) is not intended for new work rather it is used for remedial work where the wall exterior is no longer accessible.

#### PERFORMANCE DATA

| Properties  | Values   |  |
|---|--|--|
| Minimum Thickness:  | 1mm  |  |
| Minimum Application Temperature: Air                                      | +10°C  |  |
| Maximum Application Relative Humidity: Air                                | 85%  |  |
| Moisture vapour permeability BS test method 3177:1959                     | 9.4gms, mil.m <sup>2</sup> /24 hours.  |  |
| Non-toxic: approved for potable water                                     | AS4020 (int) – 1994  |  |
| Exceeds the waterproofing requirement of the US Federal spec 11-P-001411. | Tested to withstand up to 40 psi hydrostatic pressure<br><i>(Equivalent to 28 metres head of water).</i> |  |
| In-service temperatures - wet : on fully cured system                     | -20 to +55°C   |  |
| Adhesion to correctly prepared substrate                                  | 1.5MPa minimum – Concrete Failure<br>GB2567-2008. 2.77(KJ/m <sup>2</sup> ). - Concrete failure           |  |
| Laminate hardness:  | DIN-SHORE 65; PENCIL 6H  |  |
| Heat resistant  | +55°C  |  |
| Solids Volume - Mixed   | 42%  |  |
| Solids Weight - Mixed   | 56%  |  |
| SG kg/litre   | 1.25   |  |
| Surface Dry:  | +25°C ~50%RH   | 4 hours  |
| Hard Dry:   | +25°C ~ 50%RH  | 24 hours   |
| Recoat time:  | ~ Minimum  | 2 hours<br><i>In good conditions (Heat   Air flow) the second coat could be done on the same day.<br/>If you can walk on the basecoat without it “sheering” under your feet then you can apply the second coat of Aquakem.<br/>Generally the first coat will be dry enough after two (2) hours at 25°C</i> |
|   | ~ Minimum  | 24 hours   |

#### COLOURS:

Situclad EWS is available in white, may be tinted to pastel colours. Finish –semi-gloss

#### TINTING:

May be tinted to pastel colours with universal paint stainers *up to 4% by volume in Part A* before mixing two parts.

#### HEALTH & SAFETY: Refer safety data sheets (SDS).

- Avoid skin contact.
- Provide adequate ventilation.
- Wear safety equipment including clothing.

#### SUBSTRATE:

All substrates shall be stable and solid.

#### GREEN CONCRETE:

Situclad EWS can be installed on green concrete. *Normally the age of the concrete should be 28 or more days.*

Situclad EWS however may be applied at around 7 days.

However; it is preferable to allow as long as possible for the concrete to cure and dry. E.g. allow 28 days cure time after the placement of the concrete.

It is expected that when installing in this situation, the concrete will have been protected from rain since placement.

Green / saturated concrete is not a suitable base.

In all instance’s normal preparation (shot-blasting or grinding) is still required prior to the installation of the Situclad EWS.

QUALITY ASSURANCE:

The allnex approved Applicator shall ensure all QA checks have been undertaken prior to the installation process and subsequently during the installation process. The completed documentation must be made available to allnex and the client/clients authorised personnel. The product is to be installed within the required control range to ensure a fully cured hard wearing monolithic floor coating system. Information to be recorded daily is:

- Concrete sub-base or prefill mix.
  - Sequence of mixing, ratios and quantities and formula.
  - Ambient temperature | Ambient relative humidity.
- Material batch numbers used.
  - Substrate moisture content & Substrate temperature.
  - Daily detail of licenced contractors on-site.

CLEANING & MAINTENANCE:

Cleaning:  
Refer: *Cleaning Maintenance Document*

Repairs:  
Can be undertaken with further new Situclad EWS applied directly.

Resurfacing:-  

- Re-surfacing with further coats of Situclad EWS.

FIXING OF FRAMING | PLANT | MACHINERY :

Mechanical fixings into the substrate must be resin fixed. Fixings are generally installed prior to the application of the Situclad EWS. Fixings installed post the installation of the Situclad EWS must be undertaken in a manner that ensures that the completed installation remains fully waterproof.

Fixings - Installation Materials:

| Floors                 | Walls                   |
|------------------------|-------------------------|
| allnex K80 epoxy grout | allnex K125 epoxy paste |

Note  
*Epoxy injection systems may be used.*

Conventional expanding plugs, screws or anchors are not an acceptable fixing method.

PRODUCER STATEMENT:

allnex Industries Ltd state that Situclad EWS is fit for the purpose of waterproofing interior surfaces against reverse osmotic pressure and controlling moisture ingress into a building. It conforms to the relevant parts of the New Zealand Building Act.

Details:

1. E3 Internal Moisture: 1.0 Condensation control: Situclad EWS will prevent water ingress through walls and floors.

2.0 E3. Water splash: The use of Situclad EWS will act as a waterproof membrane.

3.0. E2 AS1 External Moisture
- 12.2.2 DPM materials part (e) Situclad EWS is an epoxy waterproofing membrane formulated to prevent moisture entering the structure. This product is normally used in retrofit (post applied) applications.

**Internal  
Waterproofing:  
with  
Situclad EWS**

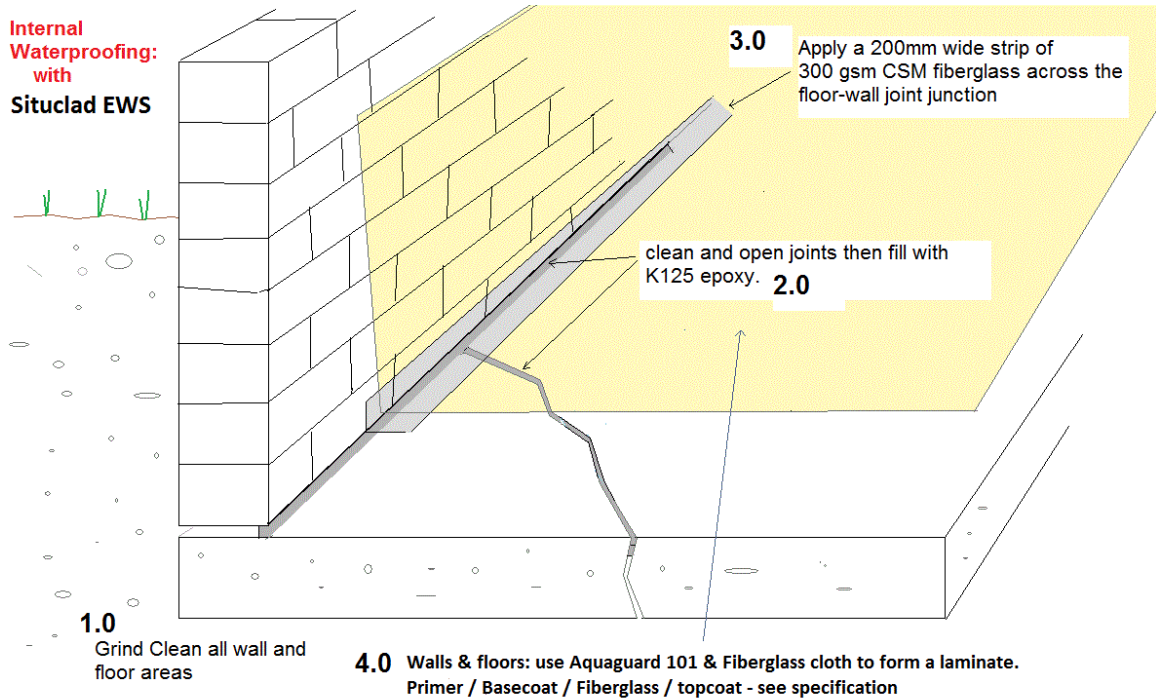

Date: March 2023  
Replaces: Nov 2019

**allnex Construction products, a Division of allnex New Zealand Ltd**  
Auckland - 14 Industry Road, Penrose, phone: 09-583-6544.  
Hamilton - 18 Somerset Street, Frankton, phone: 07-847-8658.  
Wellington - Unit 9A, 4 Glover Street, Ngauranga Gorge, phone: 04-240-0305.  
Christchurch - 112 Carlyle Street, Sydenham, phone: 03-366-6802.  
Customer Service: 0508-882-288 [cs.constructionnz@allnex.com](mailto:cs.constructionnz@allnex.com)  
[www.allnexconstruction.com](http://www.allnexconstruction.com)

**allnex**

**DISCLAIMER:** This information appearing in this Document (**Details**) concerning the product which is the subject of the Document (**Product**) is either based on present technical knowledge and tests done by allnex or tests done by, and data supplied from third parties including you, the customer. Since the actual use by you and by others of the Product is beyond the control of allnex, no warranty or representation, express or implied is made by allnex regarding the suitability for such use, nor does allnex accept any liability arising out of the use by you of other products or materials, whether third party or not, that may be referred to in this Document. allnex recommends that you carry out your own tests as to the suitability of the Product for your purpose, regarding which you accept full responsibility. In addition, if any of the Details appearing in the Document are based upon tests done by, and/or data supplied by any third party, allnex provides no warranties or representations in connection with those Details and you, the customer waives any right you may have against allnex in connection with the accuracy, completeness or otherwise of the Details. The information in this Document is not to be construed as absolutely complete or accurate since additional information may be necessary or desirable when particular or exceptional conditions or circumstances exist or because of applicable laws or government regulations affecting use of the Product. allnex does not provide any warranty or representation to you that the Product does not infringe the intellectual property rights of any third party. All orders accepted shall be subject to the standard conditions of sale of allnex which are on the back of our invoice. In accepting the Product, you, the customer acknowledge and agree: **a.)** The Product is or may be of a hazardous nature and that you, the customer, are responsible for the disposal of the container housing the Product in accordance with the requirements and regulations of the relevant supervising government. **b.)** The Product has a limited shelf life and must be stored strictly in accordance with the guidelines and specifications related to it. **c.)** Where the Details relate to Product tested by allnex, those Details are indicative only, regarding which there may be batch to batch variation. **d.)** allnex gives no warranty or representation as to the applicability for the particular use by you, the customer, of the Product and you the customer shall be responsible for ensuring that the Product is fit for your intended use. **e.)** allnex's liability for breach of any term, condition, guarantee or warranty (express or implied and concerning the information in this Document or the Product more generally) including any liability for direct or indirect consequential loss (including indirect loss of profits), is limited to the maximum extent permitted by law and, at allnex's election, to either replacing or repairing the goods or paying the cost of replacing or repairing the goods, or in the case of services, supplying the services again.